

DRC

PZ25- 12000021
11/05/2025

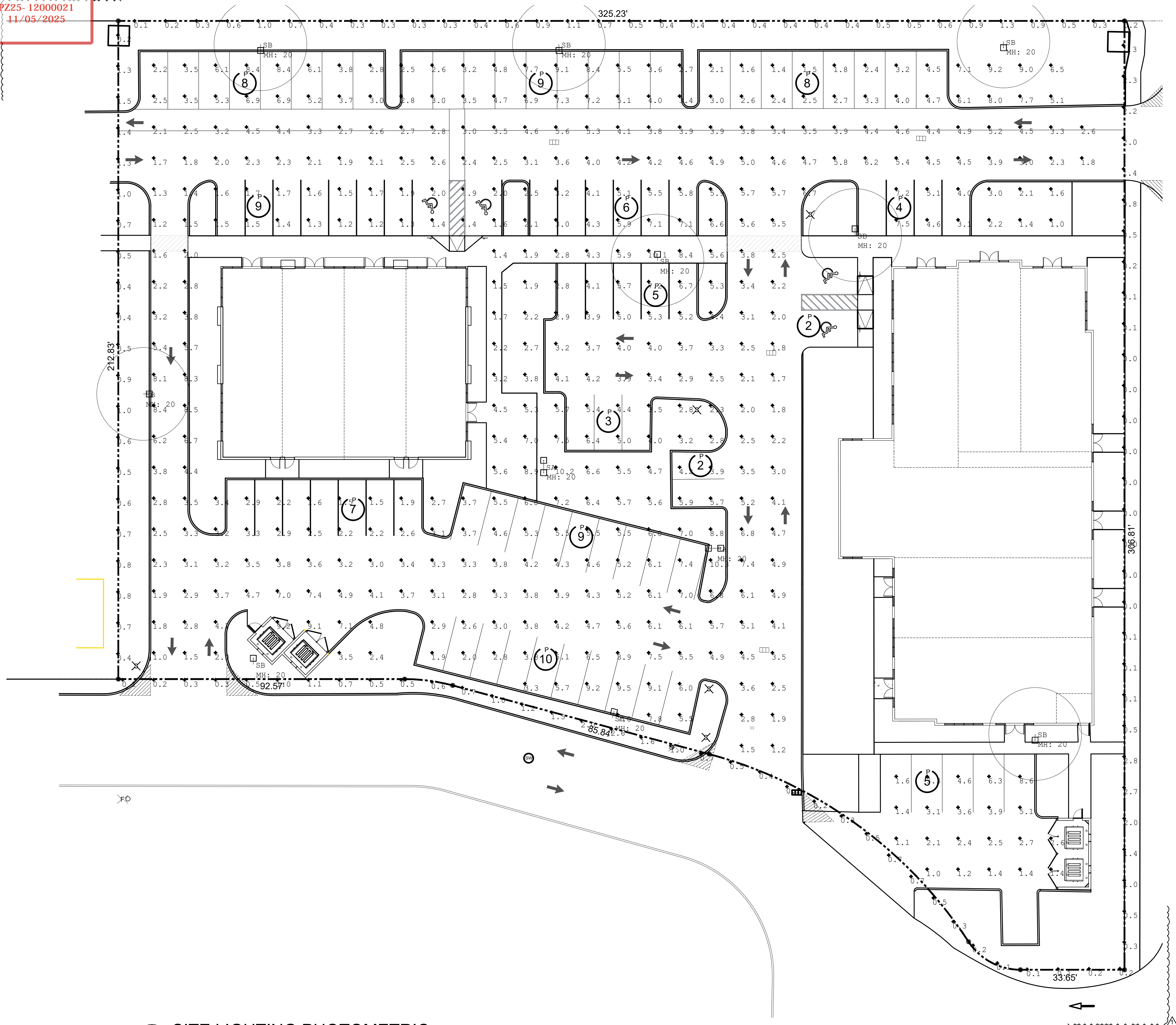

SITE LIGHTING PHOTOMETRIC

SCALE: 1/16"= 1'-0"

DTI

ARCHITECTS
Associates, Inc. AA24001933

ARCHITECTURE | PLANNING | INTERIOR DESIGN

14125 NW 80th Avenue Suite 303
Miami Lakes - Florida -33016

Info@dtiarchitect.com
www.dtiarchitect.com



Carlos Pizarro, R.A.
AR - 0013079

Revisions:

08.11.2025 BSO & ZONING

OWNER / DEVELOPER:

RED LINK MANAGEMENT
CORP

2750 NE 185TH ST. #304
AVENTURA, FLORIDA 33180

PROJECT:

FOLIO 4942-03-27-0012
PROPOSED SHELL BLDG @
2100 WEST ATLANTIC BLDG

2100 W ATLANTIC BLVD
POMPANO BEACH, FLORIDA 33069

Job Number: 24109.01

File name:

Issued Date: 05-14-2025

Drawn by: A.S

Checked by: T.R.

SHEET NAME

SITE
LIGHTING
PHOTOMETRIC

SHEET NUMBER

SP- 1.2